

4

3

2

1

REVISIONS HISTORY				
REV.	DESCRIPTION	DRAWN	DATE	APPROVED
P1-D1	INITIAL RELEASE	JA	2026-04-29	GDV
P2-D1	PCB UPDATED	JA	2026-05-04	GDV

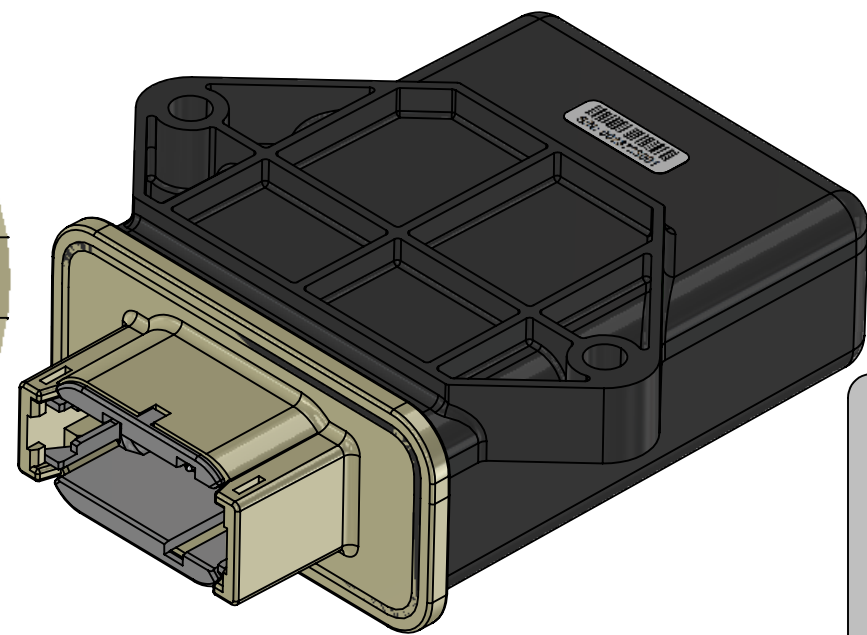
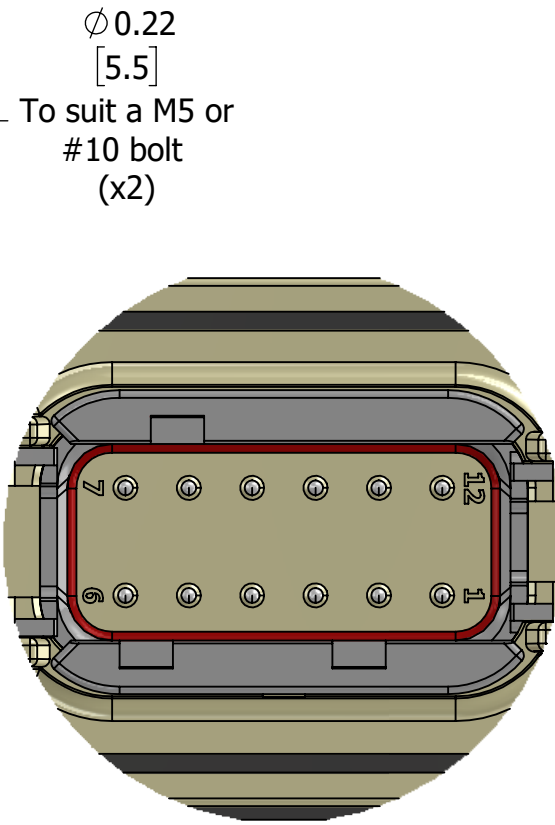
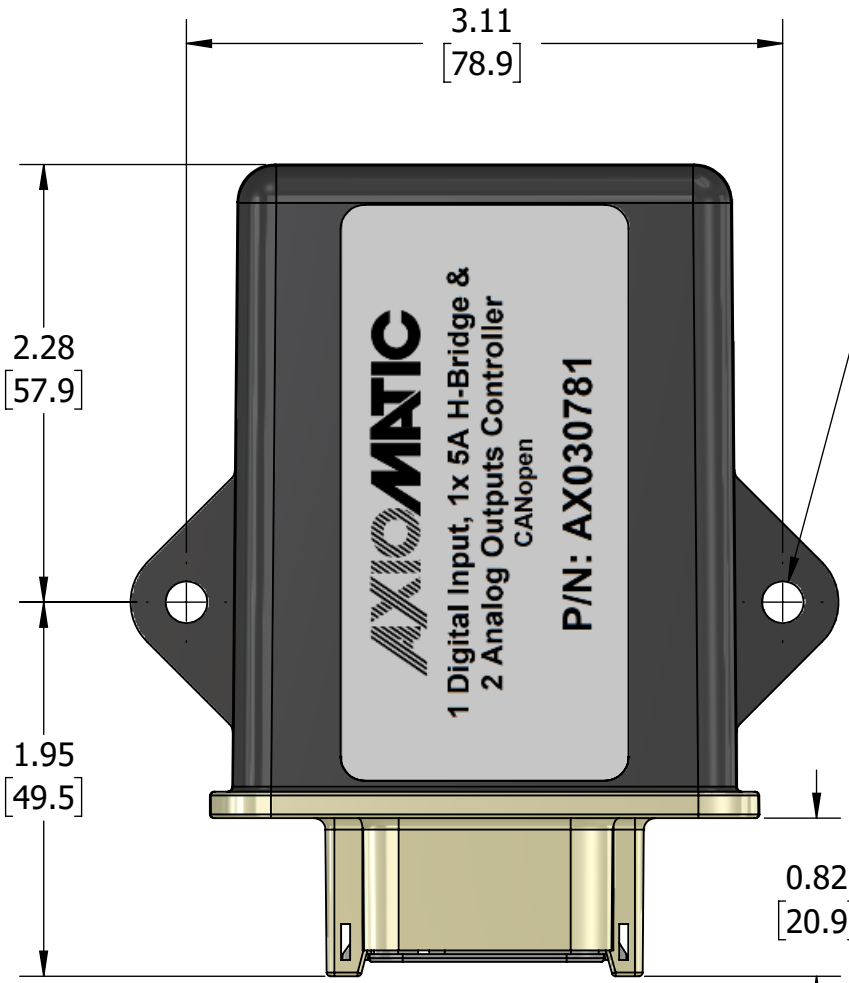

LABEL DETAIL



DETAIL A
 Molded in TE Deutch DTM04-12PA equivalent connector mates with DTM06-12SA all variations.

CONNECTOR PINOUT	
PIN #	FUNCTION
1	Digital Input
2	Digital Input Return
3	Proportional / Digital Output 1
4	Proportional / Digital Output 2
5	Ground
6	Analog Output 1
7	Analog Output 2
8	Ground
9	Battery +
10	Battery -
11	CAN High
12	CAN Low

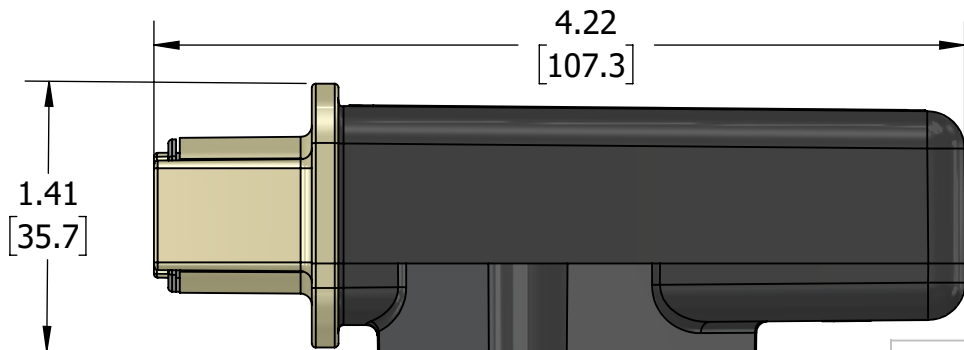
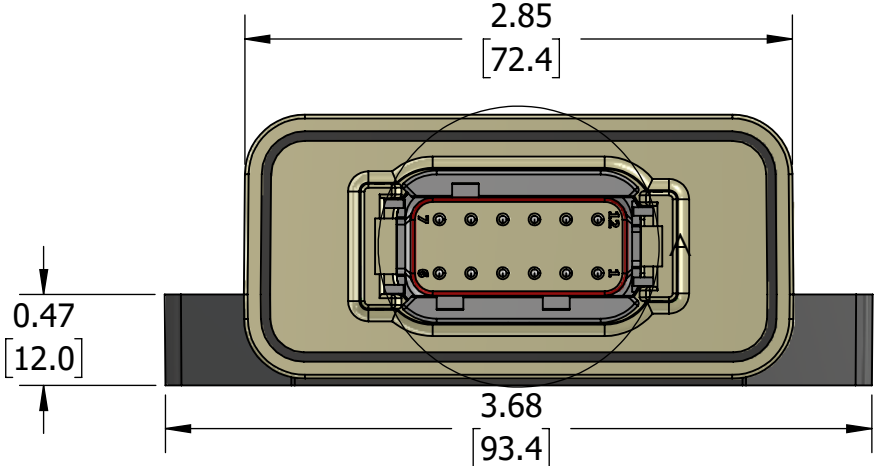

PROPRIETARY AND CONFIDENTIAL
 THE INFORMATION CONTAINED IN THIS DRAWING IS CONFIDENTIAL AND PROPRIETARY AND REMAINS THE EXCLUSIVE PROPERTY OF AXIOMATIC TECHNOLOGIES CORPORATION. THIS DRAWING MAY NOT BE USED, REPRODUCED IN WHOLE OR IN PART, NOR REVEALED TO OTHERS WITHOUT THE PRIOR WRITTEN CONSENT OF AXIOMATIC TECHNOLOGIES CORPORATION. BY ACCEPTANCE OF THIS DRAWING, THE BEARER AGREES TO THESE CONDITIONS.



DIMENSIONS ARE IN [mm] UNLESS OTHERWISE SPECIFIED IN DRAWING TOLERANCE ON: X.XXX [.XX] ± 0.008 [0.20] X.XX [X.X] ± 0.02 [0.51] X.X ± 0.4 [1.00] ANGLES ± 1.0° Others follow ISO 2768-2, tolerance class K	MATERIAL	N/A	DRAWN	JA	DATE	2026-05-04	TITLE: 1 Digital Input, 1x5A H-Bridge & 2 Analog Outputs Controller CANopen			
	FINISH	N/A	QA	EM	DATE	2026-05-04	DWG REV	DWG NO	PART REV	
	THIRD ANGLE PROJECTION	TOOL	SIZE	B	APPROVED	DATE	2026-05-04	SCALE	PART NO	SHEET
					GDV	2026-05-04	1:1	AX030781	SHEET 1 OF 1	

4

3

2

1

B

B

A

A